

## SPECIFICATION FOR APPROVAL

Model NO: B0117-02/2.5F

Item Code: 2.5 Inch LED Down Light

Model NO: V1.2

发行者: Berdis Lighting Co.,LTD.

版权者: Berdis Lighting Co.,LTD.

Customer Confirm :

| TESTED BY | CHECKED BY | APPROVED BY |
|-----------|------------|-------------|
|           |            |             |

Berdis Confirm :

| PREPARED BY | CHECKED BY | APPROVED BY |
|-------------|------------|-------------|
| Tony Lai    |            |             |

## 一、 Application:

- ★ Energy efficient: The Utilization more than 80% form electric energy into Light energy for LED, can save energy more 70% than traditional down lights;
- ★ Life time: The lifetime over 50000hs if calculated according to 50% light decay, especially suited to the lighting for a long time or the high altitude, etc;
- ★ Good light effect: Soft light, good CRI, start quickly, no flicker,;
- ★ High compatibility: LED 's installation size match traditional down light;
- ★ Input Voltage: N0N-Dimmable,AC85-265V, DimmableAC200-240V, Power Factor $\geq$ 0.9,;
- ★ Easy installation: the installation without changing the original circuit can be directly connected to AC power.
- ★ Environmental protection: LED Down light have no ultraviolet, infrared and other radiation, no mercury and other harmful substances, less heat;

Applications: LED down light have outstanding performance in Large-scale indoor lighting for that energy saving, environmental protection and lifetime, product is suitable for supermarkets, shopping malls, schools, hospitals, municipal buildings, showrooms, office, home and other indoor lighting.。

## 二、 SIZE:



## 三、Optical Specifications:

|                            |                                   |           |           |      |
|----------------------------|-----------------------------------|-----------|-----------|------|
| Power                      | 5W                                |           |           |      |
| LED Package                | SMD5730                           |           |           |      |
| LED Number                 | 10                                |           |           | PCS  |
| Light angle                | 90                                |           |           | °    |
| CRI $\geq$                 | 82                                |           |           | Ra   |
| Color temperature          | 2700-3300                         | 4000-4500 | 5700-6300 | K    |
| Luminous Efficiency $\geq$ | 80                                | 82        | 85        | LM/W |
| Illuminance $\geq$         | 1m=576 ; 2m=144 ; 3m=64 ; 4m=36 ; |           |           | LUX  |

## 四、Electric specifications:

|                                |                                     |                     |
|--------------------------------|-------------------------------------|---------------------|
| Input voltage                  | N0N-Dimmable:AC85-265V              | Dimmable:AC200-240V |
| Working frequency              | 50/60                               | Hz                  |
| LED Working current            | 280 $\pm$ 5%                        | mA                  |
| PF $\geq$                      | 90                                  | %                   |
| Power supply efficiency $\geq$ | 86                                  | %                   |
| EMC                            | C-Tick/SAA/CE/ROHS/IEC/IC-F         | *****               |
| Safety standard                | IEC 61347-2-13; AS/NZS 61347.1:2002 | A1311734EA          |

## 五、Mechanism:

|                  |          |     |
|------------------|----------|-----|
| Material         | Aluminum |     |
| AC cable length  | 150      | mm  |
| DC cable length  | 300      | mm  |
| Hole size        | Φ 75     | mm  |
| Lamp size        | Φ 90*50  | mm  |
| Protection class | IP20     | *** |

## 六、Environment:

|                       |        |     |
|-----------------------|--------|-----|
| Operating temperature | -10~40 | °C  |
| Operating humidity    | ≤85    | %RH |
| Store temperature     | -30~65 | °C  |
| Store humidity        | ≤85    | %RH |

## 七、Package:

|             |                |    |
|-------------|----------------|----|
| Box size    | L110*W110*H80  | mm |
| Carton size | L520*W215*H420 | mm |
| N.W/PCS     | 0.16           | KG |
| G.W/PCS     | 0.24           | KG |
| N.W/CTN     | 8              | KG |
| G.W/CTN     | 12             | KG |

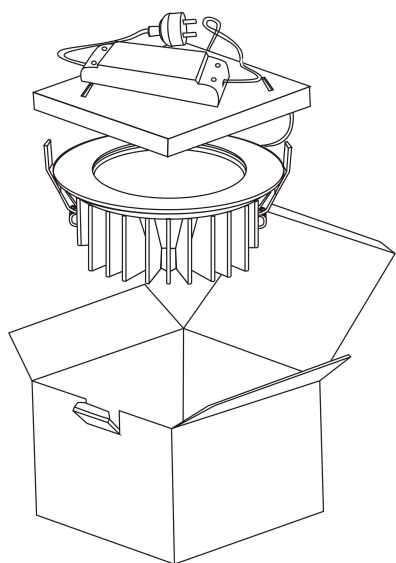

**Package diagrammatic sketch**

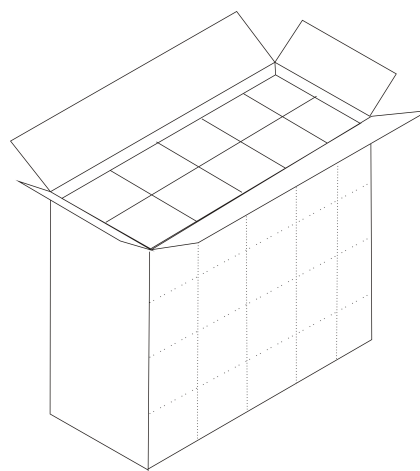

(50PCS)

**Carton diagrammatic sketch**

## 八、Diagrammatic sketch for installation:

1. Open a mounting hole A with diameter  $\phi 75\text{mm}$  as shown in figure 1:

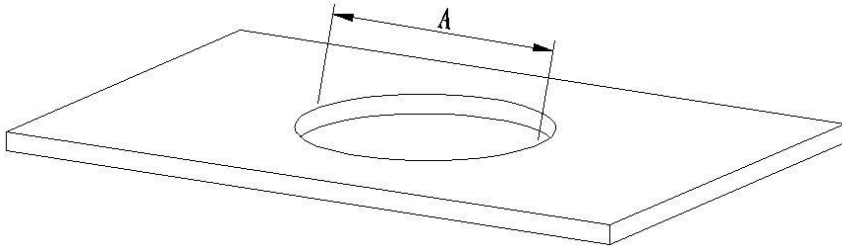

Figure 1

2. Pull out the power supply connect to the driver input, then fold up the mounting clip 90 degrees as shown in figure 2;

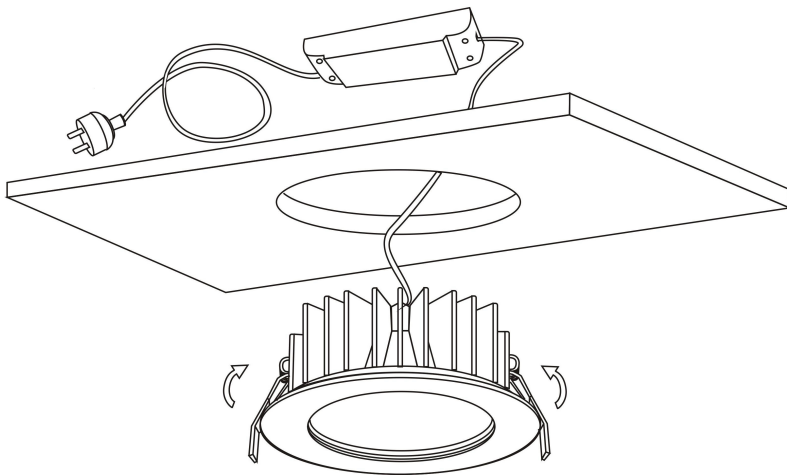

Figure 2

3. Align the mounting holes and push up of arrow direction until it is completely installed in the ceiling, turn on the power, lighting installation is complete as shown in. figure 3.;

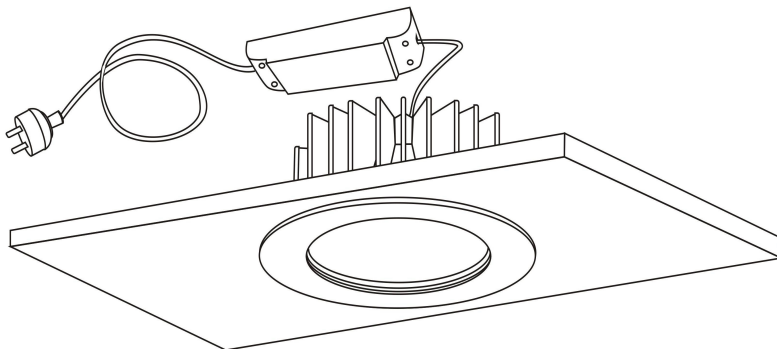

Figure 3

## 九、Manual:

. Please read the specification first to make sure the using condition is fit

- 1、 Please shut off the switch before connecting the product;
- 2、 Indoor use only;