

SPECIFICATION FOR APPROVAL

Model NO: B0104-05/3F

Item Code: 3 Inch LED Down Light

Model NO: V1.2

发行者: Berdis Lighting Co.,LTD.

版权者: Berdis Lighting Co.,LTD.

Customer Confirm :

TESTED BY	CHECKED BY	APPROVED BY

Berdis Confirm :

PREPARED BY	CHECKED BY	APPROVED BY
Tony Lai		

一、 Application:

- ★ Energy efficient: The Utilization more than 80% form electric energy into Light energy for LED, can save energy more 70% than traditional down lights;
- ★ Life time: The lifetime over 50000hs if calculated according to 50% light decay, especially suited to the lighting for a long time or the high altitude, etc;
- ★ Good light effect: Soft light, good CRI, start quickly, no flicker,;
- ★ High compatibility: LED 's installation size match traditional down light;
- ★ Input Voltage: N0N-Dimmable,AC85-265V, DimmableAC200-240V, Power Factor ≥ 0.9 ,;
- ★ Easy installation: the installation without changing the original circuit can be directly connected to AC power.
- ★ Environmental protection: LED Down light have no ultraviolet, infrared and other radiation, no mercury and other harmful substances, less heat;

Applications: LED down light have outstanding performance in Large-scale indoor lighting for that energy saving, environmental protection and lifetime, product is suitable for supermarkets, shopping malls, schools, hospitals, municipal buildings, showrooms, office, home and other indoor lighting.。

二、 SIZE:



三、Optical Specifications:

Power	10W			
LED Package	COB			
LED Number	1			PCS
Light angle	24/38			°
CRI≥	82			Ra
Color temperature	2700-3300	4000-4500	5700-6300	K
Luminous Efficiency≥	80	82	85	LM/W
Illuminance≥	1m=576 ; 2m=144 ; 3m=64 ; 4m=36 ;			LUX

四、Electric specifications:

Input voltage	N0N-Dimmable:AC85-265V	Dimmable:AC110-265V
Working frequency	50/60	Hz
LED Working current	135±5%	mA
PF≥	90	%
Power supply efficiency≥	86	%
EMC	C-Tick/RCM/TUB-CE/TUB-CB/ROHS/IEC/IC	*****
Safety standard	IEC 61347-2-13; AS/NZS 61347.1:2002	A1311734EA

五、Mechanism:

Material	PC+Aluminum	
AC cable length	150	mm
DC cable length	/	mm
Hole size	Φ 90	mm
Lamp size	Φ 100*45	mm
Protection class	IP21	***

六、Environment:

Operating temperature	-10~40	°C
Operating humidity	≤85	%RH
Store temperature	-30~65	°C
Store humidity	≤85	%RH

七、Package:

Box size	L125*W125*H88	mm
Carton size	L645*W265*H460	mm
N.W/PCS	0.28	KG
G.W/PCS	0.34	KG
N.W/CTN	14	KG
G.W/CTN	17	KG

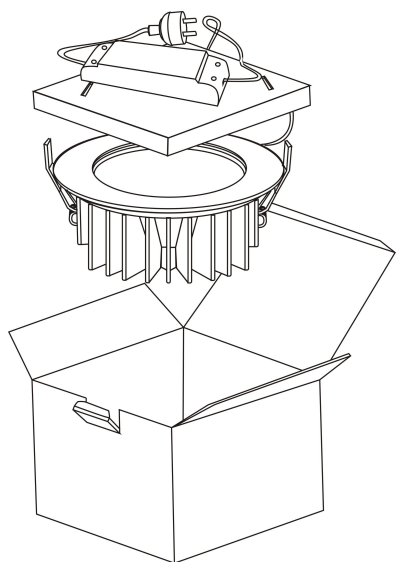

Package diagrammatic sketch

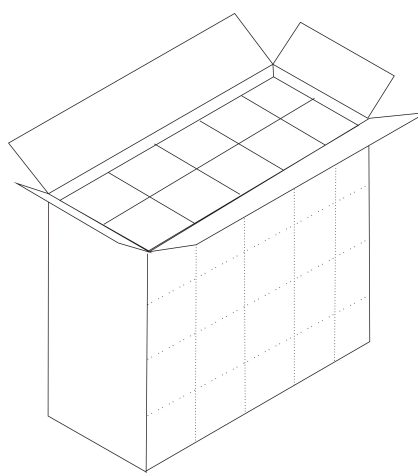

(50PCS)

Carton diagrammatic sketch

八、Diagrammatic sketch for installation:

1. Open a mounting hole A with diameter ϕ 90mm as shown in figure 1:

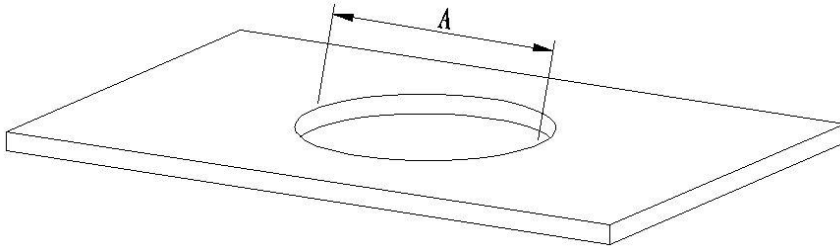

Figure 1

2. Pull out the power supply connect to the driver input, then fold up the mounting clip 90 degrees as shown in figure 2;

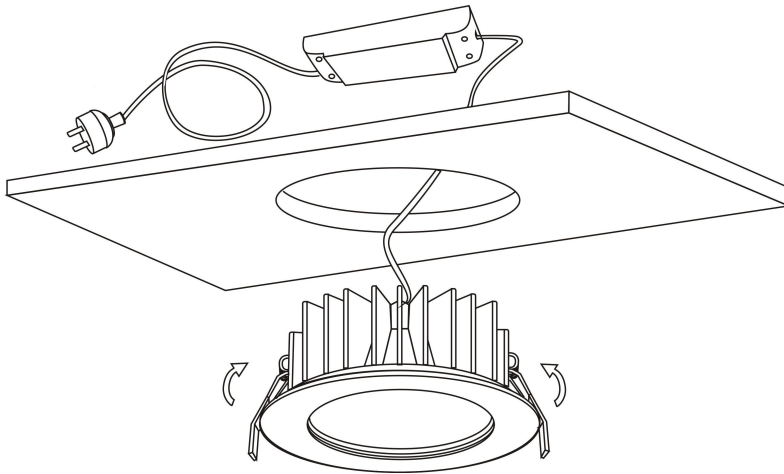

Figure 2

3. Align the mounting holes and push up of arrow direction until it is completely installed in the ceiling, turn on the power, lighting installation is complete as shown in. figure 3.;

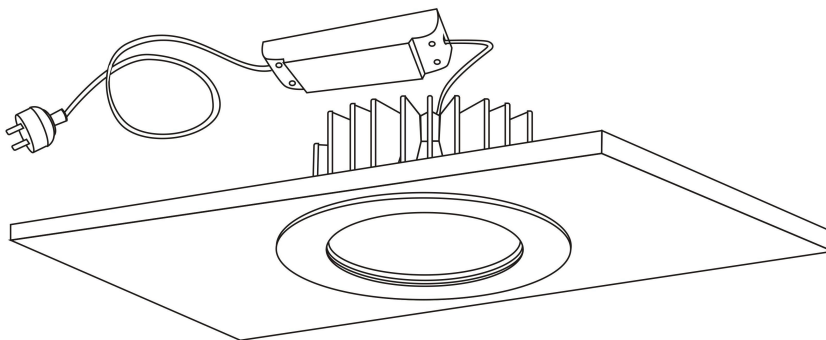

Figure 3

九、Manual:

. Please read the specification first to make sure the using condition is fit

- 1、 Please shut off the switch before connecting the product;
- 2、 Indoor use only;

十、 Test report

1. Warm white (3000±300K)

LED Optic Colorimetric Electric Comprehensive Test Report

LED Model:	B0104-05/3F	LED NUM:	0	Temperature:	25.0 °C
Test Date:	2016-09-10	Test Time:	11:10:47	Humidity:	15.0 %

Color Parameter

Dominant Wavelength:	582.8 nm	Peak Wavelength:	604.5 nm	FWHM:	122.8 nm
Color Coordinate(x,y):	(.4390,.4055)	Color Coordinate(u,v):	(.2512,.3481)	Color Purity:	0.535
Color Temperature:	3112 K	Ra:	80.15	Chromatism:	2.18 SDCM
Rc:	80.1 90.8 96.2 79.2 80.7 89.3 81.1 57.4 4.0 77.9 77.9 69.1 82.5 98.6				

Optical Parameter

Luminance:	0.00 cd/m2	Intensity:	0.00 mcd	Luminous Flux:	838.23 lm
Luminous Power:	0.00 mW	Purple Power:	0.00 mW	Optical efficiency:	82.18 lm/W

Electric Parameter

Forward Current:	0.00 mA	Forward Voltage:	223.50 V	Electric Power:	10.20mW
Reverse Current:	0.12 uA	Reverse Voltage:	0.54 V		

Spectrum Curve

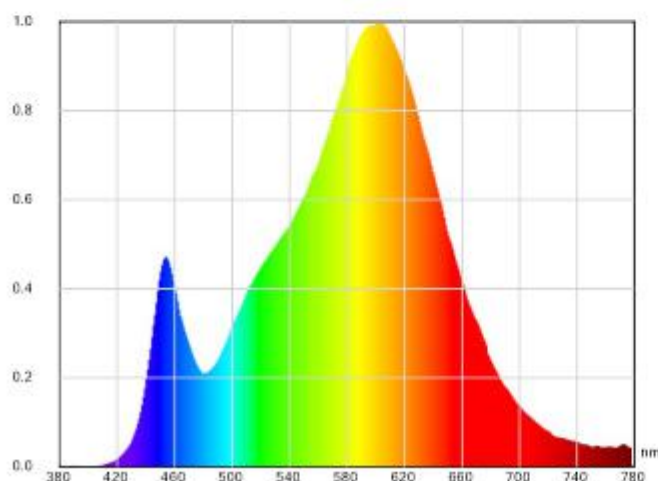

CIE1931

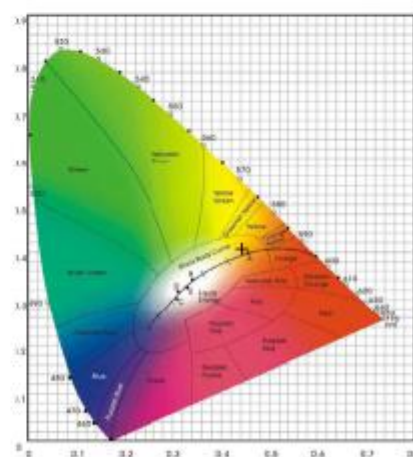

Test Apparatus Model:SSP3112 LED colour separation and light splitting test system

2. Daylight (6000±300K)

LED Optic Colorimetric Electric Comprehensive Test Report

LED Model:	B0104-05/3F	LED NUM:	0	Temperature:	25.0 ℃
Test Date:	2016-09-10	Test Time:	10:35:23	Humidity:	15.0 %

Color Parameter

Dominant Wavelength:	544.9 nm	Peak Wavelength:	453.3 nm	FWHM:	29.4 nm
Color Coordinate(x,y):	(.3312, .3453)	Color Coordinate(u,v):	(.2043, .3196)	Color Purity:	0.031
Color Temperature:	5865 K	Ra:	82.09	Chromatism:	13.96 SDCM
Rc:	85.0 91.7 94.4 84.4 84.7 86.5 89.0 73.8 26.1 77.2 83.4 62.9 87.3 97.4				

Optical Parameter

Luminance:	0.00 cd/m2	Intensity:	0.00 mcd	Luminous Flux:	836.52 lm
Luminous Power:	0.00 mW	Purple Power:	0.00 mW	Optical efficiency:	85.36 lm/W

Electric Parameter

Forward Current:	0.00 mA	Forward Voltage:	229.50 V	Electric Power:	9.8 mW
Reverse Current:	0.05 μA	Reverse Voltage:	0.92 V		

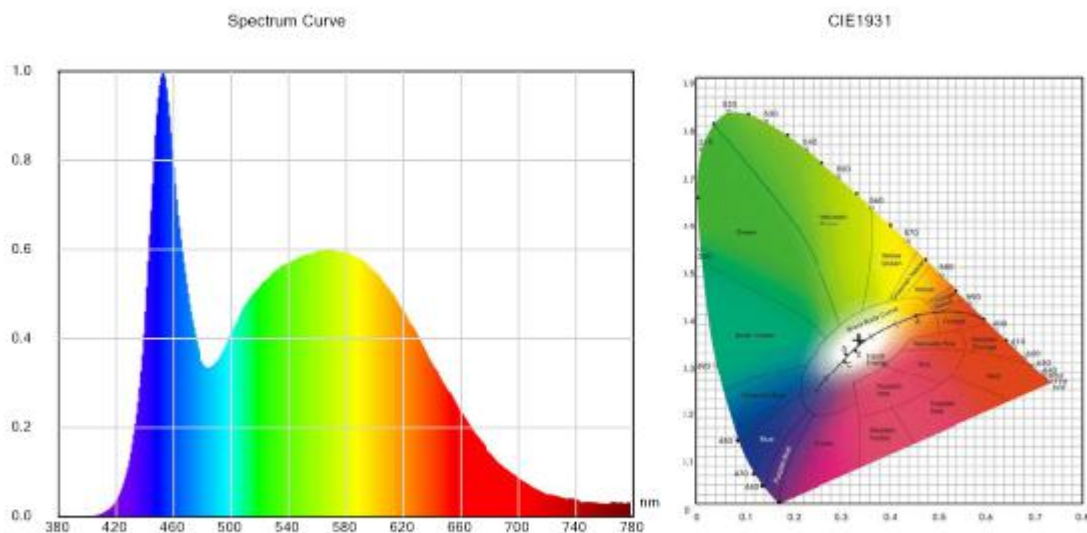

Test Apparatus Model: SSP3112 LED colour separation and light splitting test system